

LED controller continuous lighting system

LED controller continuous lighting system for surface or suspension mounting. The luminaire modules are designed to snap into sockets located at regular intervals within the Zipline extruded aluminium trunking.

Applications: Hospital, schools, social housing, data centres.

- Polycarbonate diffuser: Carefully controlled nanoprism optic version for EN12464-1 / LG7 (<math><3000\text{ cd/m}^2\text{ @ }65^\circ</math>) compliance or opal version
- Fire-retardant external plastic parts
- Designed to exclude dust, dirt and flies
- Pre-installed wiring loom, module sockets at 750 mm intervals
- Plug and socket connections between trunking joints
- Modules click fit using stainless steel spring (requires a standard screwdriver to release)
- SmartScan wireless technology removes the need for control cabling. Ideal for retro-fit



IP40

Up to 138.8 LL/CW

SMARTSCAN

LUXGUARD

Specification

Mounting	Surface Suspended	IP rating	IP40
Max presence detection height	8 m		

Lighting

Optic	Low glare diffuser Opal diffuser	Lumen output	2,380 lm - 7,680 lm
Efficacy	Up to 138.8 LL/CW		

Emergency data

Emergency lumen output	360 lm - 380 lm	Emergency type	Maintained
Emergency duration	3 hours	Battery specification	Nickel Metal Hydride (NiMH)

Power

LED power	15 W - 53 W	Circuit power	19 W - 61 W
-----------	-------------	---------------	-------------

LED characteristics

CRI	80+	Colour temperature	4000 K
Rated life (hours)	67 K - L80/B10		

Compliance

UKCA	Yes	CE	Yes
Energy efficiency class	This product contains a light source of energy efficiency class B		

Dimensions

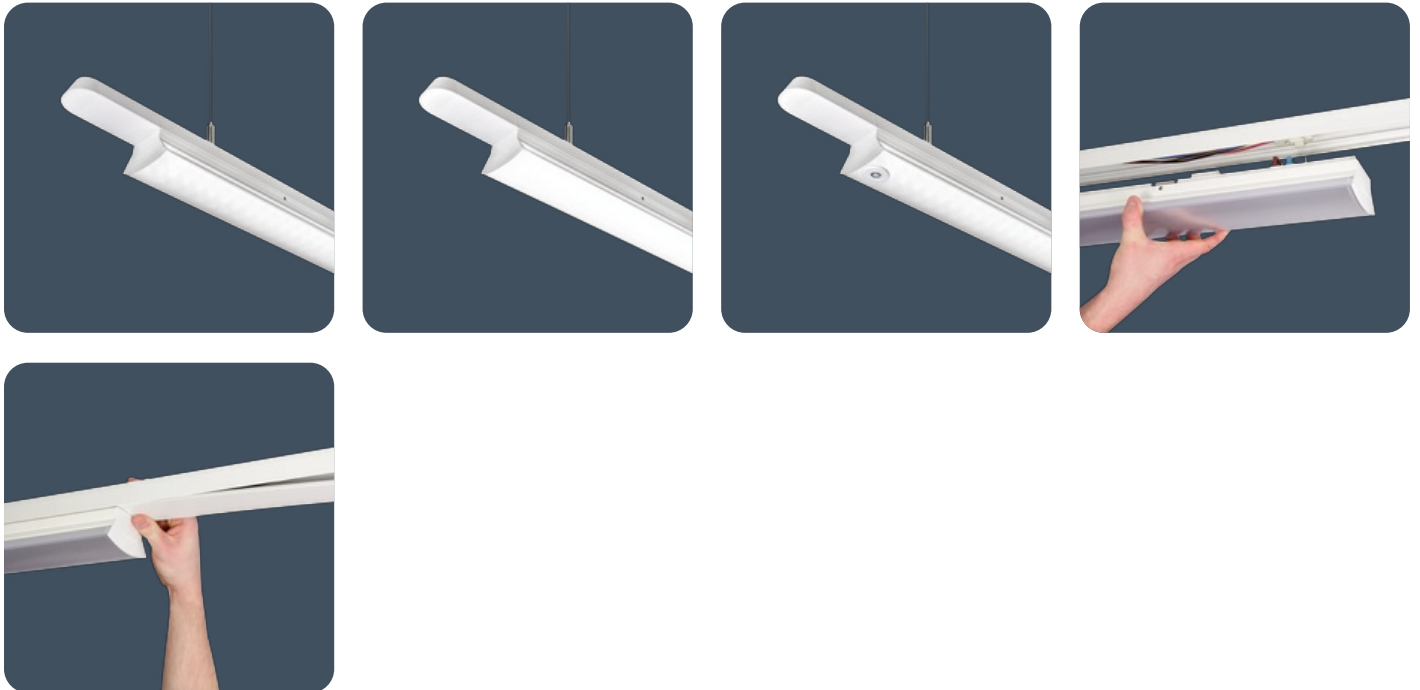
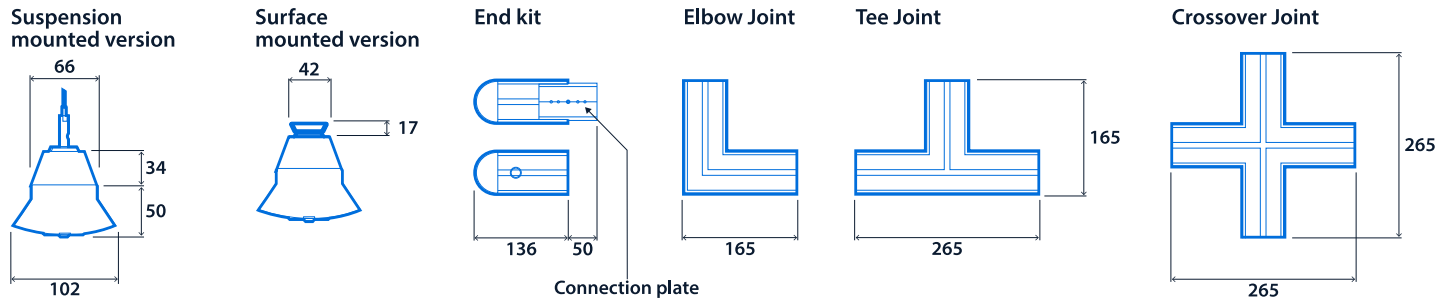



Click or scan here
View Kanby Zip variants using
our online filtering tool



Information is correct as of 20-Jan-2025, however must not be interpreted as a guarantee of individual product performance and/or characteristics. We reserve the right to alter specifications and designs without prior notice.